



isata

T R A N S S E D A N



Isata Trans Sedan	2110	2310	2320	2510	2520
GVWR:	14,050 lb.	14,050 lb.	14,050 lb.	14,050 lb.	14,050 lb.
GCWR:	20,000 lb.	20,000 lb.	20,000 lb.	20,000 lb.	20,000 lb.
Overall Length:	21' 8"	23' 8"	23' 8"	24' 6"	24' 6"
Exterior Width:	8' 2"	8' 2"	8' 2"	8' 2"	8' 2"
Wheelbase:	158"	158"	158"	176"	176"
Overall Exterior Height:	10' 5"	10' 5"	10' 5"	10' 5"	10' 5"
<small>(includes standard 13,500-BTU roof air conditioner)</small>					
Interior Height:	6' 4"	6' 4"	6' 4"	6' 4"	6' 4"
Fuel Capacity:	55 gal.	55 gal.	55 gal.	55 gal.	55 gal.
Water Capacities:	Fresh	30 gal.	30 gal.	30 gal.	30 gal.
	Grey	26 gal.	26 gal.	23 gal.	26 gal.
	Black	23 gal.	23 gal.	26 gal.	23 gal.
LPG Capacity:	12.2 gal./55 lb.	12.2 gal./55 lb.	12.2 gal./55 lb.	12.2 gal./55 lb.	12.2 gal./55 lb.

EXTERIOR FEATURES & CONSTRUCTION

Rugged, aluminum-welded frame
Block-foam insulation sidewalls and roof
Tube-steel floor assembly
One-piece TAE (Thermo Alloy Elastomer) roof
Smooth Gelcoat Fiberglass exterior walls
Exterior base coat/clear coat, full body paint and graphics
Diamond Shield® paint protection on selected impact areas
Painted front bumper cover, fog lights, painted grille
Outside lockable storage
Sewer-hose storage compartment
Locking doors for fuel and fresh water fill
Radius-corner windows
Power entry step
Patio light
Entry-assist handle
A&E® box awning
Fiberglass running boards
Jack and lug wrench
Stainless-steel wheel liners
Valve-stem extenders on rear, dual wheels
Spare tire and continental kit
Trailer hitch class 3 – 5,000 lbs.

DRIVING COMPARTMENT FEATURES

Six-way power driver and passenger captain's chairs
Color-coordinated upholstery for captain's chairs
Power steering, brakes and windows
Tilt steering column
Power remote and heated mirrors
Cruise control
Dash automotive air conditioning
Dash instrumentation: Engine temperature, fuel level, odometer, trip odometer, speedometer, oil pressure, voltmeter
Driver and passenger overhead directional reading lamps
AM/FM/CD satellite-radio ready
Intermittent windshield wipers
Power door locks (driver, passenger and entry door) with remote entry
Driver and front passenger air bags
Tinted glass in windshield, side and rear windows

LIVING SPACE FEATURES

24" Flat screen TV
Cable TV and phone hookup
Winegard® roof-mounted antenna with manual crank, 360-degree swivel and 12-volt signal booster
Satellite TV prep package
Automotive door latch and deadbolt lock on entry door
Premium-quality stain-resistant nylon carpet on thick two-lb. pad
Choice of: Whispering Willow (Green), Tan, Mink, Terra Cotta (Rust) or Stony Ridge (Grey) high-style interior-decor packages
Oak or Natural Maple framed cabinets and doors
Valances with day/night shades on windows
Privacy drape for windshield
Convection/microwave oven
Six-cu.-ft. two-way refrigerator
Lexington® jack knife sleeper sofa
Innerspring mattress w/Bedsread (2110, 2310 & 2510)
Seat belts for passengers on sofa
Water-pump switch in bath
Stainless-steel sink
Marine toilet

Tub or shower with surround
Two-burner cooktop
Power range hood
Folding range cover
Fantastic® roof vent
Emergency-exit window in rear of vehicle
Safety Features: LPG leak detector, 12-volt carbon-monoxide detector, smoke detector, fire extinguisher.

COMFORT CONTROL, ENVIRONMENTAL SYSTEMS

25,000-BTU furnace
System monitor panel
Low-profile Duo-Therm roof-mount 13,500-BTU air conditioner with ceiling ducts and vents
Demand water pump – 12-volt
City water hookup
120-volt/12-volt power converter – 45 amp
GFI 110-volt receptacle in bath
GFI 110-volt exterior receptacle
Auxiliary battery with isolator
30-ft. 110-volt power cable
4.0k Onan® gas generator
Electric-ignition 6-gal. water heater
Battery shut off (inside coach)

CHASSIS FEATURES

Ford E450
Ford® 6.8L Triton V-10 engine
(415 CID, 305-hp, 420 ft./lbs. of torque @ 3250 rpm)
Dual rear-drive wheels
LT225/75 x 16E tires with full-size spare
55-gallon fuel tank
Four-speed automatic overdrive transmission
Four-wheel ABS brakes: power front disc, rear disc
Front stabilizer bar
1.125 rear stabilizer bar
4.56 rear axle ratio
Battery control center to control and manage charging of batteries
Heavy-duty chassis/starting battery
130-amp alternator
Premium shock absorbers front and rear

WARRANTY

Conversion has a limited warranty for 1 (one) year or 15,000 miles by Dynamax Corp.
Chassis has a 3 (three) year or 36,000 mile warranty by Ford® Motor Co.
Installed appliances and fixtures are warranted by their respective manufacturer.

Ask your dealer to see a copy of the Dynamax warranty for details

POPULAR OPTIONS

Ford® 6.0L Power Stroke® DI Turbo Diesel V8 engine
(235-hp, 440 ft./lbs. of torque @ 2000 rpm)
15,000-BTU roof air conditioner
Heat strip for air conditioner
Video cassette player
Sofa in lieu of dinette
Sofa in lieu of swivel chairs
Corian® countertops
Roof rack and ladder
Aluminum-alloy wheels
Sony® DVD/CD player with Surroundsound®
Fantastic® roof vents with automatic rain sensors

Other options are available — contact your Isata Trans Sedan dealer for more information

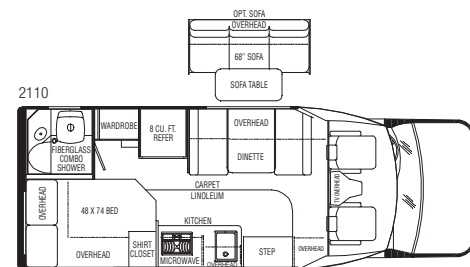

2110

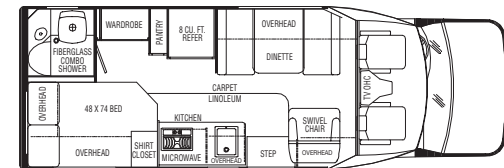

2310

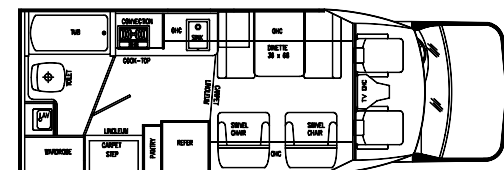

2320

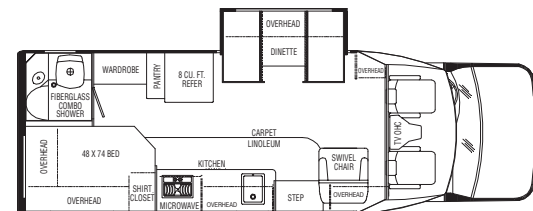

2510

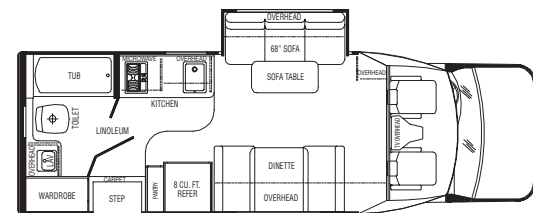

2520



A manufacturer of luxury touring vehicles

2745 Northland Dr • P.O. Box 1948 • Elkhart IN 46515
888-295-7859
www.dynamaxcorp.com

Please refer to the Owners Manual of your vehicle for further information.
Floor plans, features and specifications of the ISATA Trans Sedan are subject to change without notice.